

**PARTS DIAGRAM FOR FILM/FX™**

**Catalog #TSL5801**

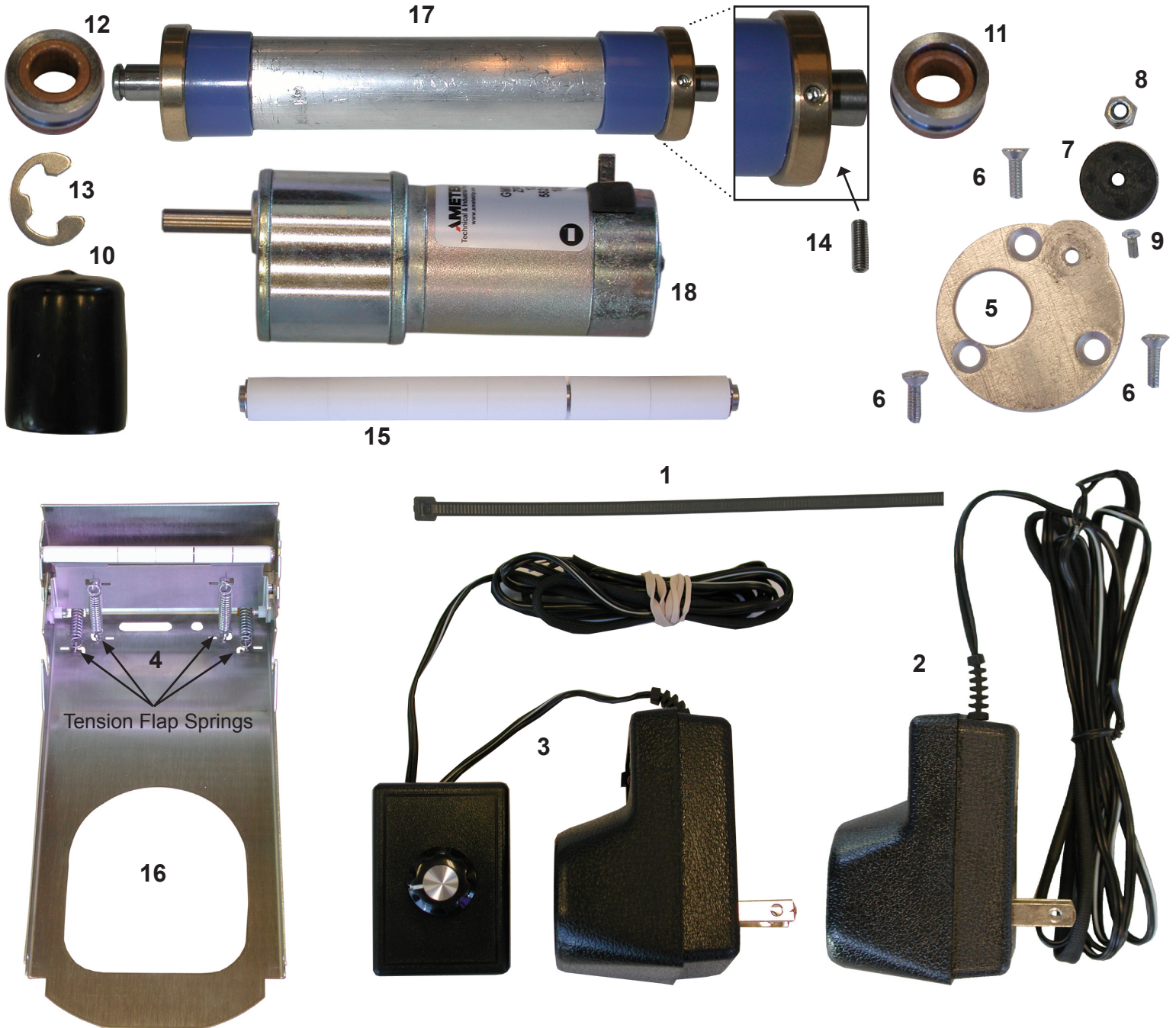

- |   |          |                                    |    |             |                         |
|---|----------|------------------------------------|----|-------------|-------------------------|
| 1 | ZPTS2-25 | Black Tie Wrap                     | 10 | ZPTSL-30    | Motor Cap               |
| 2 | ZPTS2-40 | 6-Step Transformer                 | 11 | ZPTSL-35    | Short Shaft Bushing     |
| 3 | ZPTS2-41 | 6-Step Transformer w Speed Control | 12 | ZPTSL-36    | Long Shaft Bushing      |
| 4 | ZPTSL-04 | Frame Cover Tension Flap Springs   | 13 | ZPTSL-37    | Drive Shaft E Clip      |
| 5 | ZPTSL-25 | Film/FX™ Motor Plate               | 14 | ZPTSL-38    | Drive Shaft Set Screw   |
| 6 | ZPTSL-26 | 4-40 x 3/8 in                      | 15 | ZPTSL-39    | Bottom Roller Assembly  |
| 7 | ZPTSL-27 | Locator Bushing                    | 16 | ZPTSL-41    | Complete Frame Assembly |
| 8 | ZPTSL-28 | Bushing Reach Nut                  | 17 | ZPTSL-77    | Drive Shaft Assembly    |
| 9 | ZPTSL-29 | M3 x 8mm Locator Bushing Screw     | 18 | ZPTSL-582.1 | Standard Motor          |